

SJSS-SERIES SANITARY SWIVELS

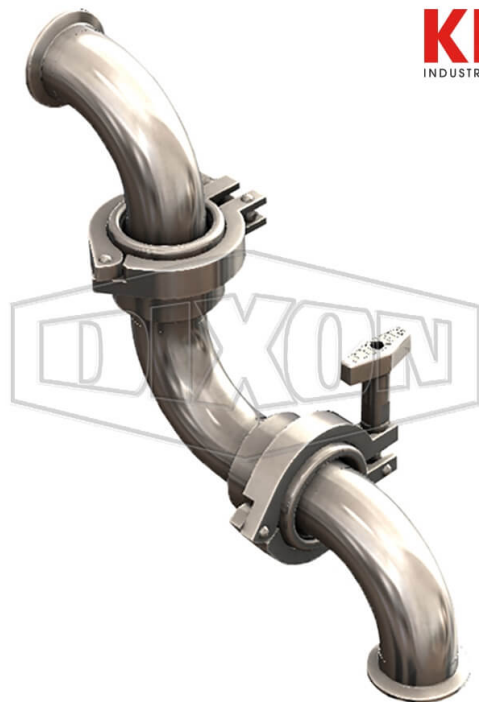

DATE
: 05/08/2026 05:51 PM

SKU
: 25462

BRAND
: DIXON VALVE

MODEL
: SJSS400SCC170

Applications:
Used to prevent hoses from kinking or making a flow path change on a flow plate.

Features:
3A COP certified

Construction:
316L Stainless Steel
PTFE with EPDM or silicone seals
Sanitary finish ID and OD

Safety notes:
WARNING: Cancer and Reproductive Harm- www.P65Warnings.ca.gov

* Referential image
** Some features may vary without prior notice. Sale subject to inventory availability

TECHNICAL SPECIFICATIONS

Connection Type	Clamp
Description	4" silicone style 70 w/ clamp ends
Material	316L Stainless Steel
Factory Part Number	SJSS400SCC170
Pressure Rating	300 PSI @ 70°F, 150 PSI @ 250°F
Seal	PTFE with silicone
Size	4"
Style	70
Weight Lb	29.3971

TECHNICAL SPECIFICATIONS