

SJSS SERIES SANITARY SWIVELS

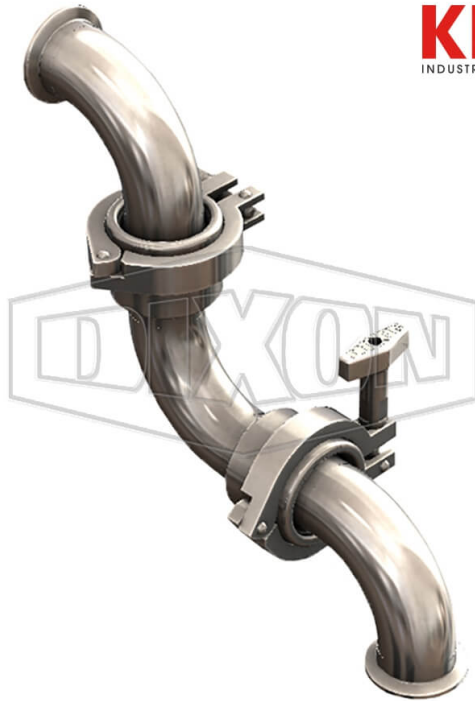

DATE
: 05/08/2026 04:41 PM

SKU
: 19428

BRAND
: DIXON VALVE

MODEL
: SJSS300SCC170

Applications:
Used to prevent hoses from kinking or making a flow path change on a flow plate.

Features:
3A COP certified

Construction:
316L Stainless Steel
PTFE with EPDM or silicone seals
Sanitary finish ID and OD

Safety notes:
WARNING: Cancer and Reproductive Harm- www.P65Warnings.ca.gov

* Referential image

** Some features may vary without prior notice. Sale subject to inventory availability

TECHNICAL SPECIFICATIONS

Connection Type	Clamp
Description	3" silicone style 70 w/ clamp ends
Material	316L Stainless Steel
Factory Part Number	SJSS300SCC170
Pressure Rating	500 PSI @ 70°F, 300 PSI @ 250°F
Seal	PTFE with silicone
Size	3"
Style	70
Weight Lb	12.3676

TECHNICAL SPECIFICATIONS