

## SJSS SERIES SANITARY SWIVELS

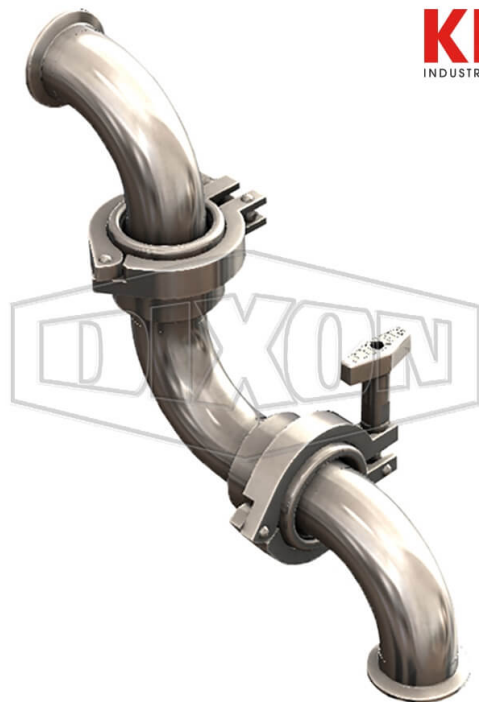

DATE  
: 05/08/2026 04:43 PM

SKU  
: 19414

BRAND  
: DIXON VALVE

MODEL  
: SJSS250SCC170

Applications:  
Used to prevent hoses from kinking or making a flow path change on a flow plate.

Features:  
3A COP certified

Construction:  
316L Stainless Steel  
PTFE with EPDM or silicone seals  
Sanitary finish ID and OD

Safety notes:  
WARNING: Cancer and Reproductive Harm- [www.P65Warnings.ca.gov](http://www.P65Warnings.ca.gov)

\* Referential image  
\*\* Some features may vary without prior notice. Sale subject to inventory availability

### TECHNICAL SPECIFICATIONS

<b>Connection Type</b>	Clamp
<b>Description</b>	2.5" silicone style 70 w/ clamp ends
<b>Material</b>	316L Stainless Steel
<b>Factory Part Number</b>	SJSS250SCC170
<b>Pressure Rating</b>	500 PSI @ 70°F,  300 PSI @ 250°F
<b>Seal</b>	PTFE with silicone
<b>Size</b>	2-1/2"
<b>Style</b>	70
<b>Weight Lb</b>	8.1931

**TECHNICAL SPECIFICATIONS**