

SJSS SERIES SANITARY SWIVELS

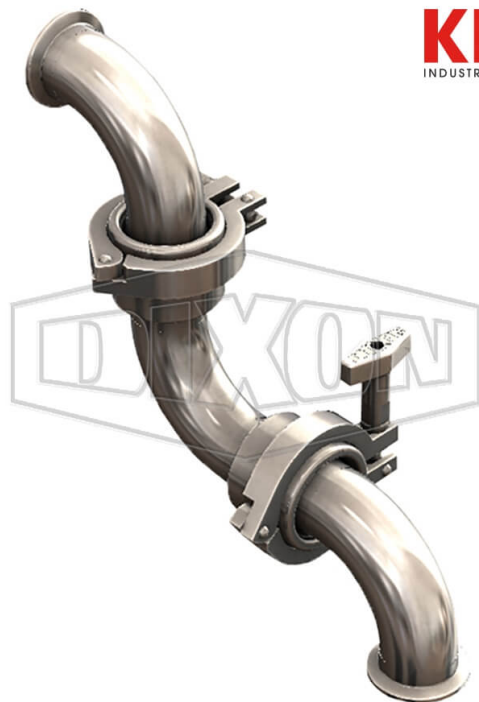

DATE
: 05/08/2026 03:49 PM

SKU
: 19393

BRAND
: DIXON VALVE

MODEL
: SJSS200ECC170

Applications:
Used to prevent hoses from kinking or making a flow path change on a flow plate.

Features:
3A COP certified

Construction:
316L Stainless Steel
PTFE with EPDM or silicone seals
Sanitary finish ID and OD

Safety notes:
WARNING: Cancer and Reproductive Harm- www.P65Warnings.ca.gov

* Referential image

** Some features may vary without prior notice. Sale subject to inventory availability

TECHNICAL SPECIFICATIONS

| | |
|----------------------------|--------------------------------------|
| Connection Type | Clamp |
| Description | 2" EPDM style 70 w/ clamp ends |
| Material | 316L Stainless Steel |
| Factory Part Number | SJSS200ECC170 |
| Pressure Rating | 500 PSI @ 70°F, 300 PSI @ 250°F |
| Seal | PTFE with EPDM |
| Size | 2" |
| Style | 70 |
| Weight Lb | 5.7593 |

TECHNICAL SPECIFICATIONS