

DIX-LOCK® N-SERIES BOWES INTERCHANGE FEMALE THREADED PLUG



DATE
: 05/22/2026 07:37 PM

SKU
: 25059

BRAND
: DIXON VALVE

MODEL
: N4BF6

Specifications:

Rated pressure for connected Steel Coupler & Steel Plug: 500 PSI (35 bar)
Maximum Working and 11,000 PSI (755 bar) Burst
Conforms to MIL-C-3486 and A-A-50431A standards

Construction:

Machined components are manufactured using solid bar stock.
Stainless steel retaining ring and spring maximize corrosion resistance and extend service life.
Steel componentry is plated using ROHS Compliant Trivalent Chrome.
Coupling sleeve constructed of cast zinc steel

Available Options:

316 stainless steel available in some versions upon request, contact Dixon

Compatibility & Interchange Data:

Bowes Interchange Bayonet Style
Interchangeable with Bowes 51000-Series, National Series 'B', MacDonald Quick-Action, Campbell Single-Lock

Safety notes:

It is important to be safe when installing quick disconnect couplings into a pneumatic circuit. Never install a pneumatic coupling directly into an air tool, use a piece of hose that is at least 18" long, between the tool and the coupling, to prevent damage to the coupling. To protect the operator, safety devices, such as a safety check valve and safety cable should be installed in case there is a hose or coupling failure.

WARNING: Cancer and Reproductive Harm- www.P65Warnings.ca.gov

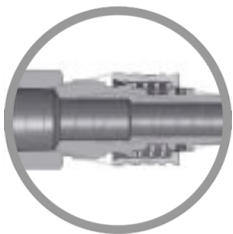

* Referential image

** Some features may vary without prior notice. Sale subject to inventory availability

TECHNICAL SPECIFICATIONS

Body Size	1/2"
Factory Part Number	N4BF6
Hex	1-3/8"
Length	3.42" (86.7mm)
Material	Steel
Maximum OD	1.50" (38.1mm)
Pressure Rating	See Product Details
Temperature Range	-40°F to +250°F (-40°C to +121°C)
Thread	BSPP
Thread Size	3/4"
Weight Lb	0.6600