

DIX-LOCK® N-SERIES BOWES INTERCHANGE FEMALE THREADED PLUG

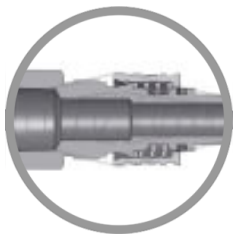

* Referential image

** Some features may vary without prior notice. Sale subject to inventory availability

DATE

: 07/10/2026 07:39 AM

SKU

: 25060

BRAND

: DIXON VALVE

MODEL

: N4BF6-B

Specifications:

Rated pressure for connected Brass Coupler & Brass Plug: 300 PSI (20 Bar)

Maximum Working and 8,200 PSI (865 Bar) Burst

Conforms to MIL-C-3486 and A-A-50431A standards

Construction:

Machined components are manufactured using solid bar stock.

Stainless steel retaining ring and spring maximize corrosion resistance and extend service life.

Coupling sleeve constructed of cast zinc steel

Available Options:

316 stainless steel available in some versions upon request, contact Dixon

Compatibility & Interchange Data:

Bowes Interchange Bayonet Style

Interchangeable with Bowes 51000-Series, National Series 'B', MacDonald Quick-Action, Campbell Single-Lock

Safety notes:

It is important to be safe when installing quick disconnect couplings into a pneumatic circuit. Never install a pneumatic coupling directly into an air tool, use a piece of hose that is at least 18" long, between the tool and the coupling, to prevent damage to the coupling. To protect the operator, safety devices, such as a safety check valve and safety cable should be installed in case there is a hose or coupling failure.

WARNING: Cancer and Reproductive Harm- www.P65Warnings.ca.gov

TECHNICAL SPECIFICATIONS

Body Size	1/2"
Factory Part Number	N4BF6-B
Hex	1-3/8"
Length	3.42" (86.7mm)
Material	Brass
Maximum OD	1.50" (38.1mm)
Pressure Rating	See Product Details
Temperature Range	-40°F to +250°F (-40°C to +121°C)
Thread	BSPP
Thread Size	3/4"
Weight Lb	0.7400