

**J-SERIES AUTOMOTIVE
PNEUMATIC FEMALE
THREADED PLUG**

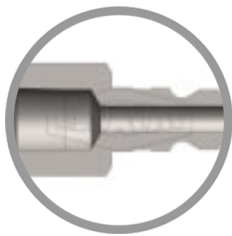

* Referential image

** Some features may vary without prior notice. Sale subject to inventory availability

DATE

: 05/23/2026 07:10 AM

SKU

: 15928

BRAND

: DIXON VALVE

MODEL

: J2F2-B

Specifications:

Rated pressure for connected Brass Coupler & Brass Plug: 300 PSI (20 bar)

Maximum Working and 10,500 PSI (724 bar) Burst

Construction:

Machined components are manufactured using solid bar stock.

Compatibility & Interchange Data:

Truflate Automotive Interchange

Parker 10 Series, Rectus 55KM and Tomco A2100/PT400

Safety notes:

It is important to be safe when installing quick disconnect couplings into a pneumatic circuit. Never install a pneumatic coupling directly into an air tool, use a piece of hose that is at least 18" long, between the tool and the coupling, to prevent damage to the coupling. To protect the operator, safety devices, such as a safety check valve and safety cable should be installed in case there is a hose or coupling failure.

WARNING: Cancer and Reproductive Harm- www.P65Warnings.ca.gov

TECHNICAL SPECIFICATIONS

| | |
|----------------------------|----------------|
| Body Size | 1/4" |
| Factory Part Number | J2F2-B |
| Hex | 11/16" |
| Length | 1.56" (39.6mm) |
| Material | Brass |
| Maximum OD | 0.79" (20.1mm) |

TECHNICAL SPECIFICATIONS

| | |
|--------------------------|-----------------------------------|
| Pressure Rating | See Product Details |
| Temperature Range | -40°F to +250°F (-40°C to +121°C) |
| Thread | NPTF |
| Thread Size | 1/4" |
| Weight Lb | 0.0800 |