

**J-SERIES AUTOMOTIVE
PNEUMATIC FEMALE
THREADED PLUG**

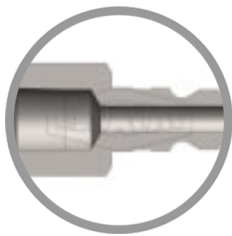

DATE
: 05/23/2026 07:10 AM

SKU
: 15926

BRAND
: DIXON VALVE

MODEL
: J2F1

Specifications:

Rated pressure for connected Brass Coupler & Steel Plug: 500 PSI (35 bar)
Maximum Working and 11,500 PSI (793 bar) Burst

Construction:

Machined components are manufactured using solid bar stock.

Compatibility & Interchange Data:

Truflate Automotive Interchange
Parker 10 Series, Rectus 55KM and Tomco A2100/PT400

Safety notes:

It is important to be safe when installing quick disconnect couplings into a pneumatic circuit. Never install a pneumatic coupling directly into an air tool, use a piece of hose that is at least 18" long, between the tool and the coupling, to prevent damage to the coupling. To protect the operator, safety devices, such as a safety check valve and safety cable should be installed in case there is a hose or coupling failure.

WARNING: Cancer and Reproductive Harm- www.P65Warnings.ca.gov

TECHNICAL SPECIFICATIONS

Body Size	1/4"
Factory Part Number	J2F1
Hex	9/16"
Length	1.34" (34.0mm)
Material	Steel
Maximum OD	0.65" (16.5mm)

* Referential image
** Some features may vary without prior notice. Sale subject to inventory availability

TECHNICAL SPECIFICATIONS

Pressure Rating	See Product Details
Temperature Range	-40°F to +250°F (-40°C to +121°C)
Thread	NPTF
Thread Size	1/8"
Weight Lb	0.0500