

MULTI-PLANE HOSE SWIVEL

DATE
: 05/05/2026 04:47 AM

SKU
: 27401

BRAND
: DIXON VALVE

MODEL
: DAC1010

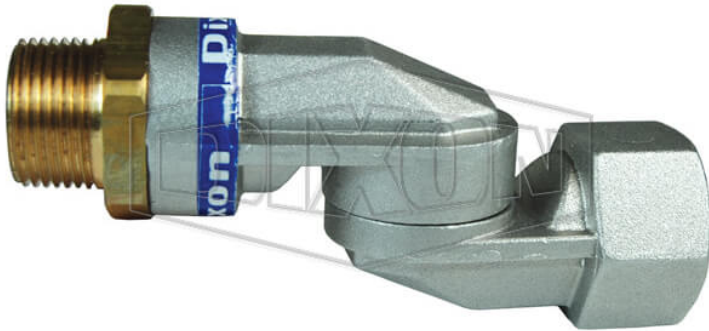

Features:

- Brass male end will not gall in nozzle castings
- Dual O-rings seal with all fuels
- Machined brass sleeve gives smooth seal surface- no leaks
- Internal nylon retainer cord secures firmly but allows free rotation

Construction:

- Body: Machined aluminum casting
- Male End: Machined brass bar stock
- Sleeve: Machined brass bar stock

Safety notes:

WARNING: Cancer and Reproductive Harm- www.P65Warnings.ca.gov

* Referential image
** Some features may vary without prior notice. Sale subject to inventory availability

TECHNICAL SPECIFICATIONS

Female Thread	NPT
Female Thread Size	1"
Male Thread	NPT
Male Thread Size	1"
Factory Part Number	DAC1010
Weight Lb	1.3000