

CAM & GROOVE ADAPTER SOCKET WELD TO SCHEDULE 40 PIPE

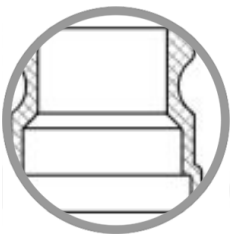

* Referential image

** Some features may vary without prior notice. Sale subject to inventory availability

DATE
: 05/22/2026 12:49 AM

SKU
: 6482

BRAND
: DIXON VALVE

MODEL
: 801AWSPAL

Applications:

Designed for use with liquids, consult Dixon for specific recommendations

Specifications:

No standard exists for the 8" fittings, and generally does not interchange with other manufacturers.

Safety notes:

Under no circumstances should cam and groove couplings be used for compressed air or steam service!

Final weld preparation, as with all weld fittings, is the responsibility of the welder.

Line drawings are for reference only. Consult Dixon for specific dimensions.

Dixon and Boss-Lock cam and groove couplings do not interchange in the 8" size.

Pressure rating recommendations are based on the use of mating Dixon fittings at ambient temperature 70°F (21°C) with a standard Buna-N seal installed. For use at elevated temperature or other unusual operating conditions, consult Dixon.

WARNING: Cancer and Reproductive Harm- www.P65Warnings.ca.gov

TECHNICAL SPECIFICATIONS

Material	356T6 Aluminum
Maximum Operating Pressure	50 PSI
Factory Part Number	801AWSPAL
Size	8"
Weight Lb	4.0000