

DQC E-SERIES STRAIGHT THROUGH INTERCHANGE FEMALE COUPLER

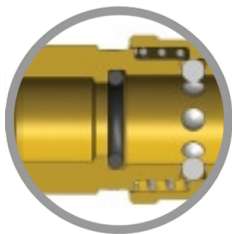

* Referential image

** Some features may vary without prior notice. Sale subject to inventory availability

DATE

: 05/22/2026 02:56 PM

SKU

: 4900

BRAND

: DIXON VALVE

MODEL

: 4EBF4-B

Specifications:

Rated pressure for connected Brass Coupler and Brass Plug: 2400 PSI (166 bar) Maximum Working and 9700 PSI (669 bar) burst

Rated pressure for connected Brass Coupler and 303 Stainless Steel Plug: 3500 PSI (241 bar) Maximum Working and 14000 PSI (966 bar) burst

Features:

Straight-Through Pressure-Wash Interchange

Interchanges with Parker ST, Foster FST, Hansen ST, and Tomco ST couplings

These couplers have no internal valves, providing maximum flow with minimum pressure drop.

Construction:

Machined components are manufactured using solid brass

Stainless steel balls, retaining rings and spring maximize corrosion resistance and extend service life.

Nitrile (Buna-N) seals are standard

Available Options:

Contact Dixon® for additional seal material options, pressure ratings and other technical information.

Safety notes:

Do Not Disconnect with pressure in line.

Dixon cannot assume liability for misapplication of products resulting in equipment down-time, lost production, property damage and/or personal injury including death.

WARNING: Cancer and Reproductive Harm- www.P65Warnings.ca.gov

TECHNICAL SPECIFICATIONS

Body Size	1/2"
Burst Pressure	8,800 PSI (607 Bar)
Factory Part Number	4EBF4-B
Female Thread	BSPP
Female Thread Size	1/2"-14
Hex	1-1/8"
Length	1.86" (47.2mm)
Material	Brass
Maximum OD	1.34" (34.0mm)
Maximum Operating Pressure	2,200 PSI (152 Bar)
Seal	Buna-N
Temperature Range	-40°F - +250°F (-40°C - +121°C)
Weight Lb	0.3900