

DIXON CAM & GROOVE TYPE C COUPLER X HOSE SHANK

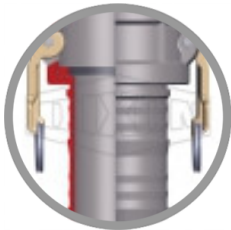

* Referential image

** Some features may vary without prior notice. Sale subject to inventory availability

DATE

: 05/22/2026 01:09 PM

SKU

: 22479

BRAND

: DIXON VALVE

MODEL

: 400-C-MI

Applications:

Designed for use with liquids, consult Dixon for specific recommendations

Use:

Suitable for use with King Crimp™ sleeves and ferrules

Specifications:

Produced to interchange with all product produced to Commercial Item Description A-A-59326D

Features:

Precision machined to rigid tolerances

Stainless pins will not rust or bind, providing great strength and safety

Recess holds gasket firmly in place- ensures proper placement

Long shank design allows proper banding, thus eliminating the major cause of hose damage

Construction:

Buna-N gasket

Durable stainless steel cam arm pins

Supplied with safety clips

Available Options:

Other gasket types are available, contact Dixon.

How it works:

To make a connection, simply slide the adapter into the coupler and with normal hand pressure, press the cam levers down.

Uncoupling is as quick and simple as coupling. Just lift the cam arms and remove the adapter.

Safety notes:

Under no circumstances should cam and groove couplings be used for compressed air or steam service!

Pressure rating recommendations are based on the use of mating Dixon fittings at ambient temperature 70° with a standard seal installed. For use at elevated temperature or other unusual operating conditions, consult the factory.

Only use the crimp style shanks with the crimp style sleeves and ferrules. Due to differences in dimensions and tolerances for safety reasons, do not interchange other manufacturer's products with Dixon products.

WARNING: Cancer and Reproductive Harm- www.P65Warnings.ca.gov

TECHNICAL SPECIFICATIONS

Material	Unplated Ductile Iron
Maximum Operating Pressure	100 PSI, 150 PSI with King Crimp Ferrule system
Factory Part Number	400-C-MI
Seal	Buna-N
Size	4"
Weight Lb	6.7500