

DIXON® CAM & GROOVE TYPE C COUPLER X HOSE SHANK

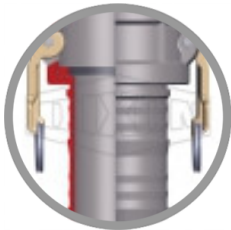

* Referential image

** Some features may vary without prior notice. Sale subject to inventory availability

DATE

: 06/10/2026 03:33 PM

SKU

: 575

BRAND

: DIXON VALVE

MODEL

: 125-C-SS

Applications:

Designed for use with liquids, consult Dixon for specific recommendations

Specifications:

Produced to interchange with all product produced to Commercial Item Description A-A-59326D

Features:

Precision machined to rigid tolerances

Stainless pins will not rust or bind, providing great strength and safety

Recess holds gasket firmly in place- ensures proper placement

Long shank design allows proper banding, thus eliminating the major cause of hose damage

Construction:

Buna-N gasket

Durable stainless steel cam arm pins

Supplied with safety clips

Available Options:

Other gasket types are available, contact Dixon.

How it works:

To make a connection, simply slide the adapter into the coupler and with normal hand pressure, press the cam levers down.

Uncoupling is as quick and simple as coupling. Just lift the cam arms and remove the adapter.

Safety notes:

Under no circumstances should cam and groove couplings be used for compressed air or steam service!

Pressure rating recommendations are based on the use of mating Dixon fittings at ambient temperature 70°F with a standard seal installed. For use at elevated temperature or other unusual operating conditions, consult Dixon.

WARNING: Cancer and Reproductive Harm- www.P65Warnings.ca.gov

TECHNICAL SPECIFICATIONS

| | |
|-----------------------------------|---------------------|
| Factory Part Number | 125-C-SS |
| Material | 316 Stainless Steel |
| Maximum Operating Pressure | 250 PSI |
| Seal | Buna-N |
| Size | 1-1/4" |
| Weight Lb | 1.5000 |